

Supplement 1
(July 1, 1991)

Recommended Practice for Guarding of Pumping Units

API RECOMMENDED PRACTICE 11ER (RP 11ER)
SECOND EDITION, JANUARY 1, 1990

American Petroleum Institute
1220 L Street, Northwest
Washington, DC 20005



**Issued by
AMERICAN PETROLEUM INSTITUTE
Production Department**

**FOR INFORMATION CONCERNING TECHNICAL CONTENT OF
THIS PUBLICATION CONTACT THE API PRODUCTION DEPARTMENT,
1201 MAIN STREET, SUITE 2535, DALLAS, TX 75202-3904 — (214) 748-3841.
SEE BACK COVER FOR INFORMATION CONCERNING HOW TO OBTAIN
ADDITIONAL COPIES OF THIS PUBLICATION.**

**Users of this publication should become familiar with its scope and content,
including any provisions it may have regarding marking of manufactured products. This
document is intended to supplement rather than replace individual engineering judgment.**

OFFICIAL PUBLICATION



REG. U.S. PATENT OFFICE

Copyright © 1991 American Petroleum Institute

Foreword

This supplement contains revisions authorized at the 1990 Standardization Conference as reported in Circ PS-1920 and was approved as an editorial change.

Page 4. *Replace Par. 4.1.d.(1) with:*

Fig 4.1 shows the relationship, to provide reasonable safety between the maximum size opening permitted in a guard and the distance from the moving part. Thus up to $\frac{3}{8}$ in. (9,5 mm) openings are permitted below $1\frac{1}{4}$ in. (31,8 mm) from a moving part, up to $\frac{1}{2}$ in. (12,7 mm) openings at distances $1\frac{1}{4}$ in. (31,8 mm) and above, $\frac{3}{8}$ in. (15,9 mm) openings at distances of $3\frac{1}{2}$ in. (88,9 mm) and above, etc.

Page 4. *Delete the word "brakes" from Paragraphs 3.1 and 3.1.a.*

Page 5. Par 4.3(a): *Replace the word "be" with the word "by" in the first sentence.*

Page 6. *Delete from Fig. 4.1 the $6\frac{1}{4}$ inch step between the $5\frac{1}{4}$ and $7\frac{1}{4}$ inch steps.*

Page 9. Par. 8.4(a): *Change the second sentence to read:*

For side step or offset fixed ladder sections at landings, the side rail or rungs shall be extended to the next regular run above 42 in. (1066,8 mm).

Page 15. *Change the "16. in. min. CL" in Fig. A.6 to "15 in. min. CL."*

Order No. 811-05206

Additional copies available from
AMERICAN PETROLEUM INSTITUTE
Publications and Distribution Section
1220 L Street, NW
Washington, DC 20005
(202) 682-8375



Recommended Practice for Guarding of Pumping Units

**API RECOMMENDED PRACTICE 11ER (RP 11ER)
SECOND EDITION, JANUARY 1, 1990**

American Petroleum Institute
1220 L Street, Northwest
Washington, DC 20005



POLICY

1. API PUBLICATIONS NECESSARILY ADDRESS PROBLEMS OF A GENERAL NATURE. WITH RESPECT TO PARTICULAR CIRCUMSTANCES, LOCAL, STATE AND FEDERAL LAWS AND REGULATIONS SHOULD BE REVIEWED.
2. API IS NOT UNDERTAKING TO MEET DUTIES OF EMPLOYERS, MANUFACTURERS OR SUPPLIERS TO WARN AND PROPERLY TRAIN AND EQUIP THEIR EMPLOYEES, AND OTHERS EXPOSED, CONCERNING HEALTH AND SAFETY RISKS AND PRECAUTIONS, NOR UNDERTAKING THEIR OBLIGATIONS UNDER LOCAL, STATE, OR FEDERAL LAWS.
3. NOTHING CONTAINED IN ANY API PUBLICATION IS TO BE CONSTRUED AS GRANTING ANY RIGHT, BY IMPLICATION OR OTHERWISE, FOR THE MANUFACTURE, SALE, OR USE OF ANY METHOD, APPARATUS, OR PRODUCT COVERED BY LETTERS PATENT.

NEITHER SHOULD ANYTHING CONTAINED IN THE PUBLICATION BE CONSTRUED AS INSURING ANYONE AGAINST LIABILITY FOR INFRINGEMENT OF LETTERS PATENT.

4. GENERALLY, API STANDARDS ARE REVIEWED AND REVISED, REAFFIRMED, OR WITHDRAWN AT LEAST EVERY FIVE YEARS. SOMETIMES A ONE-TIME EXTENSION OF UP TO TWO YEARS WILL BE ADDED TO THIS REVIEW CYCLE. THIS PUBLICATION WILL NO LONGER BE IN EFFECT FIVE YEARS AFTER ITS PUBLICATION DATE AS AN OPERATIVE API STANDARD OR, WHERE AN EXTENSION HAS BEEN GRANTED, UPON REPUBLICATION. STATUS OF THE PUBLICATION CAN BE ASCERTAINED FROM THE API AUTHORIZING DEPARTMENT (TEL. 214-748-3841). A CATALOG OF API PUBLICATIONS AND MATERIALS IS PUBLISHED ANNUALLY AND UPDATED QUARTERLY BY API, 1220 L ST., N.W., WASHINGTON, D.C. 20005.

Issued by
AMERICAN PETROLEUM INSTITUTE
Production Department

FOR INFORMATION CONCERNING TECHNICAL CONTENTS OF
THIS PUBLICATION CONTACT THE API PRODUCTION DEPARTMENT,
2535 ONE MAIN PLACE, DALLAS, TX 75202-3904 — (214) 748-3841.
SEE BACK COVER FOR INFORMATION CONCERNING HOW TO OBTAIN
ADDITIONAL COPIES OF THIS PUBLICATION.

Users of this publication should become familiar with its scope and content,
including any provisions it may have regarding marking of manufactured products. This
document is intended to supplement rather than replace individual engineering judgment.

OFFICIAL PUBLICATION



REG. U.S. PATENT OFFICE

Copyright © 1990 American Petroleum Institute

TABLE OF CONTENTS

	Page
Foreword.....	2
Section 1: Introduction	3
Section 2: Types of Guarding to be Used on Pumping Unit	3
Section 3: Items to be Guarded	4
Section 4: Requirements for Guarding	4
Section 5: Equivalent Safety	8
Section 6: Caution Signs and Color Coding	8
Section 7: Pumping Unit Brake	8
Section 8: Ladders and Platforms	9
Appendix A: Examples of Guarding Equipment	10

FOREWORD

a. This recommended practice is under the jurisdiction of the API Committee on Standardization of Production Equipment.

b. It is intended that this recommended practice provide a guideline for the guarding of moving parts of oil well pumping units. It is based on knowledge and experience gained through the application of guards for pumping units by the production segment of the petroleum industry over a period of many years.

c. In preparing this recommended practice, the group responsible has selected and extracted specifications and recommendations from the following publications: American National Standards Institute (ANSI): *Safety Requirements for Floor and Wall Openings, Railings, and Toe Boards, A12.1-1973** and American National

Standard: *Safety Standard for Mechanical Power Transmission Apparatus, ANSI B15.1-1972.***

d. Metric conversions of customary units are included throughout the text as parenthesized numbers. The following factors were used in making these conversions:

- (1) Inches (in.) were converted to millimeters (mm) by multiplying inches by 25.4 and rounding to one place to right of decimal point.
- (2) Pounds per linear foot (lb/ft) were converted to kilograms per meter (kg/m) by multiplying by 1.448164 and rounding to two places to right of decimal point.
- (3) Pounds (lb) were converted to kilograms (kg) by multiplying by 0.4535924 and rounding to two places to right of decimal point.

*Available from American National Standards Institute, 1430 Broadway, New York, N.Y. 10018.

**Published by The American Society of Mechanical Engineers, 345 East 47th Street, New York, N.Y. 10017.

This Standard (supplement) shall become effective on the date printed on the cover but may be used voluntarily from the date of distribution.

Attention Users of This Publication: Portions of this publication have been changed from the previous edition. The locations of changes have been marked with a bar in the margin. In some cases the changes are significant, while in other cases the changes reflect minor editorial adjustments. The bar notations in the margins are provided as an aid to users to identify those parts of this publication that have been changed from the previous edition, but API makes no warranty as to the accuracy of such bar notations.

NOTE

This is the second edition of this recommended practice. It was accepted for publication at the 1989 Standardization Conference.

Requests for permission to reproduce or translate all or any part of the material published herein should be addressed to the Director, Production Department, American Petroleum Institute, 2535 One Main Place, Dallas TX 75202-3904.

SECTION 1 INTRODUCTION

1.1 Purpose. This recommended practice provides a reference or guide for the design, manufacture, and installation of guards for oil well pumping units. It is based on practices which experience has shown to be functionally safe and practical.

1.2 Scope. This recommended practice is intended to provide safeguards for all persons who are required to work around or on oil well pumping units.

- a. These safeguards should prevent bodily injury from contact with moving parts by anyone inadvertently walking into, falling, slipping, tripping, or similar action. The safeguards should also prevent injury from reasonable or predictable breakage of any of the component parts.
- b. It is anticipated that persons who will be exposed to the hazards involved with the moving parts of a pumping unit are adults who are able-bodied and physically capable of performing useful work; they may be expected to be of normal intelligence and able to act with reasonable decorum and caution. They may also be expected to be aware of the potential hazards involved. The general public

normally will not have access to the area where pumping units are located. Pumping units generally are in rural and fairly remote locations on private leases where the public would be trespassing.

- c. Where unattended locations present close exposure to a community of people, safety barriers, such as provided by a totally enclosed and locked perimeter, may be required. [See Par. 4.3a(3).]

1.3 Policy. This API recommended practice may be used by anyone desiring to do so, and every effort has been made by the Institute to assure the accuracy and reliability of the data contained in it. However, the Institute makes no representation, warranty or guarantee in connection with the publication of any API specification or recommended practice and hereby expressly disclaims any liability or responsibility for loss or damage resulting from their use, for any violation of any federal, state, or municipal regulation with which an API specification or recommended practice may conflict, or for the infringement of any patent resulting from the use of an API specification or recommended practice.

SECTION 2 TYPES OF GUARDING TO BE USED ON PUMPING UNIT

2.1 The general types of guards include those listed below or combinations thereof.

- a. **Enclosures and Guardrails.** Enclosures usually provide the greatest degree of protection against moving parts of mechanical equipment. Guardrails sometimes offer less effective protection than enclosures of proper dimension and the use of guardrails shall be confined to protecting against slow moving equipment such as cranks, counterweights, air counterbalance tanks and horseheads. Both enclosures and guardrails should be strong enough to withstand the impacts and loadings

imposed upon them without collapsing against the moving mechanism they protect against, and their dimensions should be within the limits prescribed in Section 4.

- b. **Location.** This refers to equipment which, because of its location, is not accessible to employees performing normal operating or maintenance procedures. Where a hazard would exist during maintenance, the equipment should be shut down and all power locked out or the equipment guarded in accordance with Par. 4.1 or 4.2.

SECTION 3 ITEMS TO BE GUARDED

3.1 The following parts of a pumping unit should be guarded: (Components except brakes, sheaves and belts may be considered to be guarded by location if they are not easily accessible during operation of the unit due to the presence of other guards or moving components.)

- a. **Brakes, Sheaves and Belts.** Brakes, sheaves and belts on pumping units should be guarded by removable enclosures. An example of a typical enclosure is shown in Fig. A.1, Appendix A.
- b. **Cranks, Counterweights and Air Counterbalance Tanks.** Cranks, counterweights and air counterbalance tanks should be guarded either by enclosures or guardrails. The use of guardrails for this application has proven adequate because cranks, counterweights and air balance tanks are slow moving pieces of equipment and because there is no reason for an employee to perform maintenance or do other types of work on this equipment while the unit is in operation. Either enclosures or guardrails should be far enough from the moving parts to protect the employee from inadvertent contact but not so far that the employee might be tempted to use the space as a

passageway. An example of a guardrail is shown in Fig. A.2, Appendix A.

- c. **Flywheels.** Flywheels on gas engine prime movers for pumping units should be guarded by enclosures. The design of this enclosure should permit temporary access to the flywheel when necessary for engine starting. An example flywheel enclosure is shown in Fig. A.3, Appendix A.

d. Horsehead and Carrier Bar.

- (1) In those instances where the horsehead or carrier bar descends to less than 84 inches from the ground or work platform, a securely fastened single or standard guardrail shall be installed. Examples of horsehead guards are shown in Fig. A.4, Appendix A.
- (2) The need for guarding the carrier bar and the polished rod stuffing box shear point is not deemed necessary if the following practice is observed: *the carrier bar, polished rod clamps and polished rod liner clamps shall not travel within six inches of the top of the stuffing box on the down stroke.*

SECTION 4 REQUIREMENTS FOR GUARDING

4.1 Enclosures.

- a. The enclosure prevents inadvertent placing of any part of the body in, on or over edges of the guard where it might contact a moving part.
- b. The enclosure shall be constructed of expanded metal, perforated or solid sheet metal, wire mesh, plastic or other material of equivalent or greater strength to meet requirements of Par. 4.1.c and 4.1.d. Such material shall be free from burrs or sharp edges. Enclosure guards shall be securely attached to the base or framework of the pumping unit, engine, gear case, motor, etc., or securely affixed to ground or foundation.
- c. The enclosure and its supports shall be designed with sufficient rigidity so that an adult person leaning on, or falling against the enclosure will not sustain an injury from the moving part.

- d. Enclosure openings should conform to the requirements of Fig. 4.1, shown graphically in Fig. 4.2 and 4.3, all extracted from ANSI-B15.1-1984: *Safety Standard For Mechanical Power Transmission Apparatus*.*

- (1) Fig. 4.1 shows the relationship, to provide reasonable safety, between the maximum size opening permitted in a guard and the distance from the moving part. Thus, up to $\frac{1}{4}$ in. (6.4 mm) openings are permitted below $1\frac{1}{4}$ in. (31.8 mm) from a moving part, up to $\frac{1}{2}$ in. (12.7 mm) openings at distances $2\frac{1}{2}$ in. (63.5 mm) and above, $\frac{3}{4}$ in. (22.2 mm) openings at distances of $6\frac{1}{2}$ in. (165.1 mm) and above, etc.

*Extracted with the permission of the publisher, The American Society of Mechanical Engineers, 345 East 47th Street, New York, N.Y. 10017 (Metric conversions were added in this publication).

- (2) When the guard is partially open on the machine side as shown in Fig. 4.2, the distance to the moving part is a variable based on the opening A, and should be the lesser of either the distance B or the distance C + D (the sum of the depth of the guard lip and the distance from the edge of the lip to the moving part).
- e. Openings to permit lubrication, adjustment or inspection should be equipped with hinged, sliding, or bolted cover plates of a design that will stay closed while the opening is not in use.

4.2 Guardrails.

- a. A guard railing consists of top rail, intermediate rail or equivalent protection, and posts, with a vertical height within the range of 36 in. (914.4 mm) to 48 in. (1219.2 mm) nominal from upper surface of top rail to floor, platform, runway, or work level. The top rail should be smooth-surfaced throughout the length of the railing. The intermediate rail should be installed approximately halfway between the top rail and the floor, platform, runway, or work level. Mesh, crossbars or other designs may also be used. The ends of the rails should not overhang the terminal posts, except where such overhang does not constitute a projection hazard. Many units are elevated above grade. If the guardrail is attached to the unit frame the lower rail may be too high above grade. Guardrails may require field modification to accommodate this condition.
- b. Minimum requirements for guard railings are as follows:
- (1) The railing shall be designed and constructed to withstand a load of 25 pounds per linear foot (37.20 kg/m) applied in any direction at the top of the railing. The intermediate rail shall be capable of withstanding a horizontal load of 20 pounds per linear foot (29.76 kg/m). The end terminal posts shall be capable of withstanding a load of 200 pounds (90.72 kg) applied in any direction at the top of the post. The above loads are not additive.*

- c. Guardrails shall have a minimum horizontal clear distance between the rail and the face of the moving part of 15 in. (381.0 mm) and a maximum horizontal clearance of 42 in. (1066.8 mm). Guardrail height at minimum horizontal clearance shall be 48 in. (1219.2 mm). Proportioned decrease in rail height to a minimum of 36 in. (914.4 mm) is permitted with increasing horizontal clearance providing that the 36-in. (914.4 mm) minimum rail height is not effected with less than 36 in. (914.4 mm) horizontal clearance from the face of the moving part. When the guardrail horizontal clearance exceeds 20 in. (508.0 mm), signs should be posted to warn against the use of the space between as a passageway while the machinery is operating.

4.3 Guarding by Location.

- a. Equipment guarded by location shall be remoteness from the working areas remove the foreseeable risk of contact by persons.
- (1) To be guarded by location or position, any moving part should be at least 84 in. (2133.6 mm) above the walkway, platform or walking level.
 - (2) Where Par. 4.3.a and 4.3.a(1) cannot be complied with, the guarding shall be in accordance with Par. 4.1 or 4.2.
 - (3) Equipment may be considered to be guarded by location when in an enclosed area with a locked entrance. The area should have either walls or a fence of a minimum height of 96 in. (2438.4 mm). Mechanical Power Transmission components should be individually guarded in compliance with Par. 4.1 and 4.2 unless the source of power to or within all prime movers is automatically shutdown when the entrance is opened. Manual restart will be required.

*This material is reproduced with permission from American National Standard A12.1: *Safety Requirements for Floor and Wall Openings, Railings, and Toeboards*, copyright 1978 by the American National Standards Institute (ANSI), copies of which may be purchased from the American National Standards Institute at 1430 Broadway, New York, N.Y. 10018. (Metric conversions were added in this publication and are not the responsibility of ANSI).

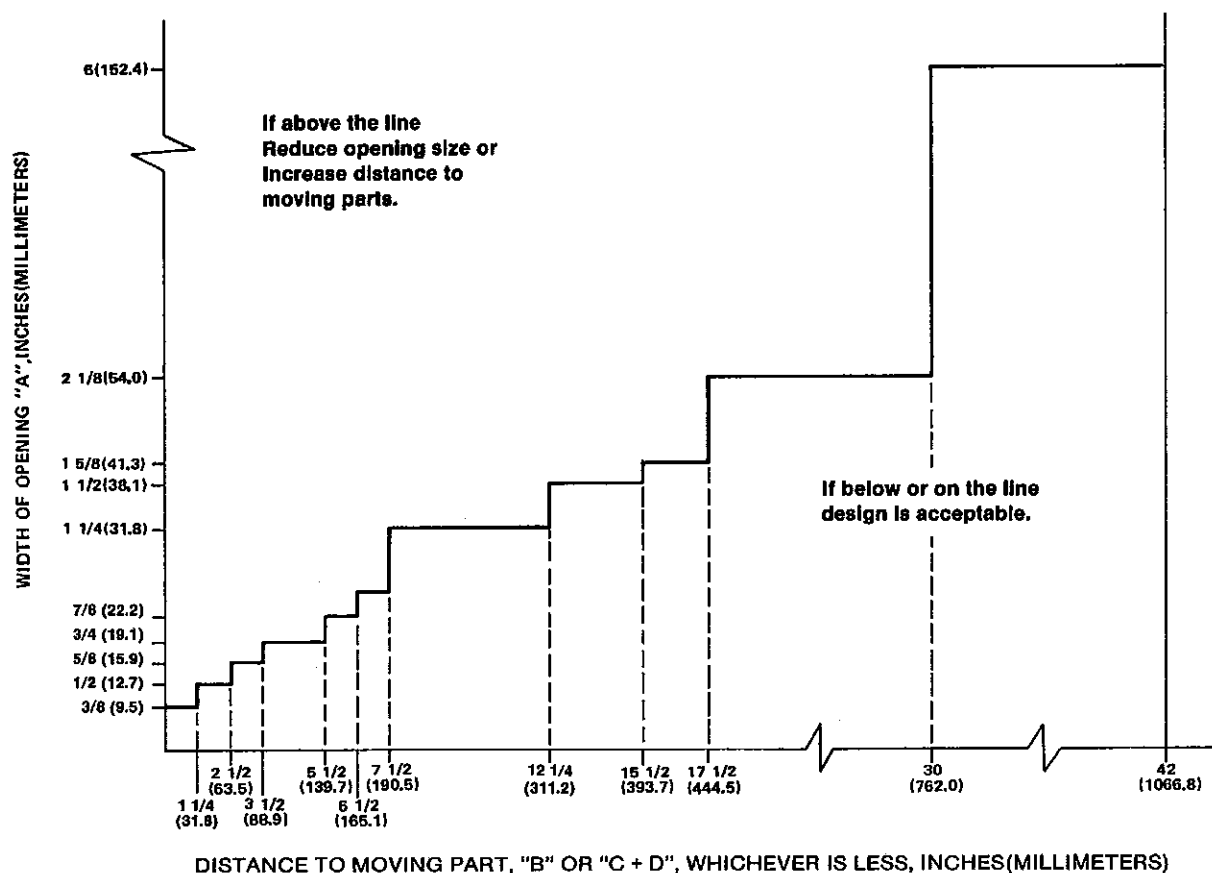

FIG. 4.1
DISTANCE TO MOVING PART REQUIREMENTS

Fig. 4.2
MEASUREMENT OF DISTANCE
REQUIREMENTS LISTED IN FIG. 4.1

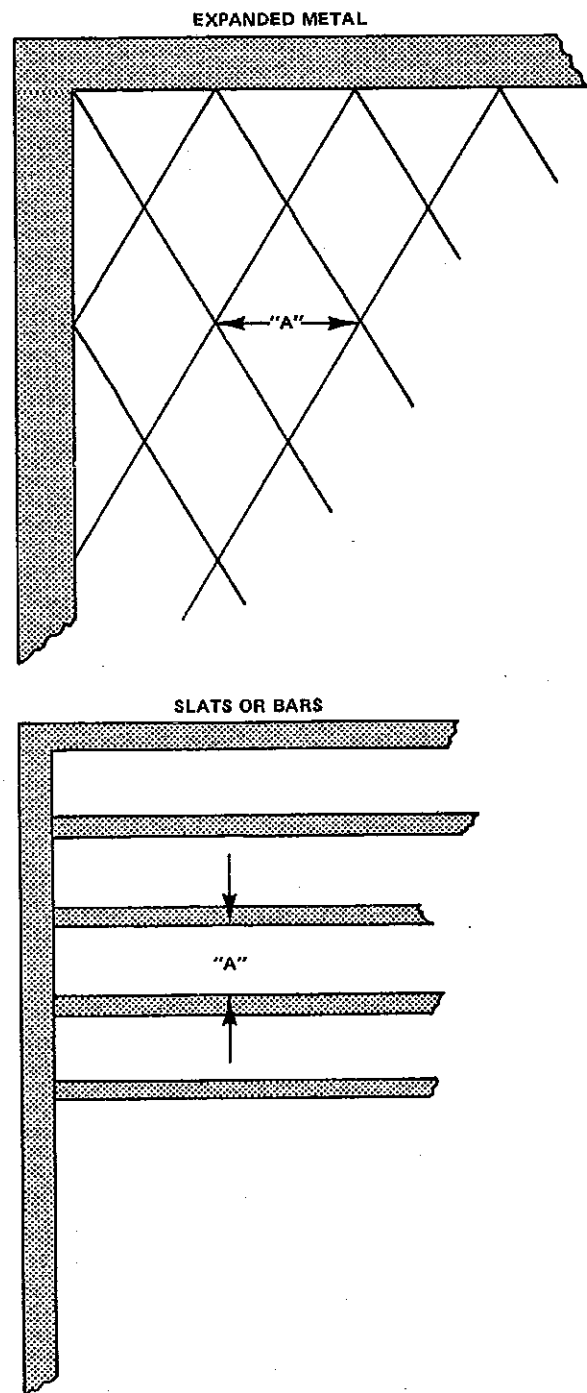

FIG. 4.3
METHOD OF MEASURING OPENING "A"
(FIG. 4.1)

SECTION 5 EQUIVALENT SAFETY

5.1 Where specific devices or methods are mentioned in this recommended practice, other devices or methods which will provide equivalent safety may be substituted.

SECTION 6 CAUTION SIGNS AND COLOR CODING

6.1 At the option of the operator, signs and color coding for marking physical hazards may be used to extend and augment the protection afforded by enclosures and guards.

- a. **Signs.** Signs should conform to the current ANSI Z35.1-19XX: Specifications for Accident Prevention Signs.

b. **Color Coding.** A bright, contrasting color such as orange or yellow should be used for designating dangerous parts of machines or energized equipment, which may cut, crush, shock or otherwise injure, and to emphasize such hazards. An example of areas of the pumping unit components to be color coded are shown in Fig. A.5, Appendix A.

SECTION 7 PUMPING UNIT BRAKE

7.1 For operational purposes the pumping unit brake and engine clutch handles should extend or be accessible outside the pumping unit counter-balance guard.

7.2 The pumping unit brake is not intended as a safety stop but is intended for operational stops only.

7.3 When operations or maintenance are to be conducted on or around a pumping unit, the position of the crankarms and counterweights should be securely fixed in a stationary position by chaining or other acceptable means.

SECTION 8 LADDERS AND PLATFORMS

8.1 General Requirements. Ladders are provided to give access to the walking beam and/or some of the structural bearings to help in the erection of the unit and for maintenance purposes. The lower flange of the walking beam is considered to be the landing level.

- a. Ladders are not intended to be used during the operation of the unit.
- b. Care should be taken to locate ladders such as not to create a hazardous condition. A person should not be required to enter the crank swing area to use a ladder.
- c. Clearance on the climbing side of the ladder shall be 30 in. (762 mm) minimum. See Fig. A.6. Side clearance on ladders without cages shall be 15 in. (381 mm) minimum each way from the centerline of the ladder.
- d. Toe clearance on the back side of the ladder shall be 7 in. (177.8 mm) minimum. See Fig. A.6. For unavoidable obstructions, see Fig. A.7.

8.2 Design Requirements. All ladders, attachments, and fastenings shall be designed of steel to meet the following:

a. Load Requirements.

1. The minimum design live load shall be a single concentrated load of 200 lb. (90.9 Kg).
2. The number and position of additional concentrated live-load units of 200 lb. each as determined from anticipated usage shall be considered in the design.
3. The live loads imposed by persons occupying the ladder shall be considered to be concentrated at such points as will cause the maximum stress in the structural member being considered.
4. The weight of the ladder and attachments together with the live load(s) shall be considered in the design of rails and fastenings.

b. Configuration. All rungs or cleats shall have a minimum diameter of $\frac{3}{4}$ in. (19 mm) or be made of other suitable section with at least the same strength. The center to center distance between rungs shall not exceed 12 in. (304.8 mm) and shall be uniform throughout the length of the ladder. The minimum clear length of rungs shall be 16 in. (406.4 mm). Side rails shall be of such cross section as to afford adequate gripping surface.

c. Quality of Finish. All parts of the ladder shall be free of burrs, sharp edges, or projections. Any

splices in side rails shall have a smooth transition with original members and with no sharp or extended projections.

d. Inclination. Ladders should always be securely attached on a pitch of 75° to 90° from the horizontal.

8.3 Cages. Cages shall be provided on ladders of more than 20 feet (6096 mm) to a maximum unbroken length of 30 feet (9144 mm).

a. The length of a ladder, not its height, determines the requirement for a cage. The bottom of a ladder is considered to be the top of the bottom rung or cleat, not the ground or landing elevation. Thus the ladder length is measured from the top of the bottom rung to the top of the top rung or landing level. Ladder extensions which provide safe access to a landing are not considered part of the ladder when determining the ladder length.

b. The cage shall extend a minimum of 42 in. (1066.8 mm) above the top of the landing and shall extend down the ladder to a point not less than 7 feet (2133.6 mm) nor more than 8 feet (2438.4 mm) above the bottom of the ladder. The bottom portion of the cage shall be flared not less than 4 in. (101.6 mm). Cages shall not extend less than 27 in. (685.8 mm) nor more than 28 in. (711.2 mm) from the centerline of the rungs of the ladder. The cage shall not be less than 27 in. (685.8 mm) in width. The inside shall be clear of projections.

Vertical bars shall be located at a maximum spacing of 40° around the circumference of the cage; this will give a maximum spacing of approximately $9\frac{1}{2}$ in. (241.3 mm), center to center. Caged ladders shall be built as shown in Fig. A.9.

8.4 Landing Platforms. Landing platforms are commonly used on larger structures. The maximum distance from the bottom of the ladder to the top of the landing floor shall be 20 feet (6096 mm) or 30 feet (9144 mm) if the ladder is caged.

a. The ladders (or grab bars on step-through types) shall extend a minimum of 42 in. (1066.8 mm) above the landing. The side rails or rungs shall be extended to the next regular rung above 42 in. (1066.8 mm). See Fig. A.8. One of the rungs shall be level with the landing.

b. All landing platforms shall be equipped with railings and toeboards arranged in such a manner as to give safe access to the ladder. Minimum width of platforms shall be 24 in. (609.6 mm) and minimum length shall be 30 in. (762 mm).

APPENDIX A
EXAMPLES OF GUARDING EQUIPMENT

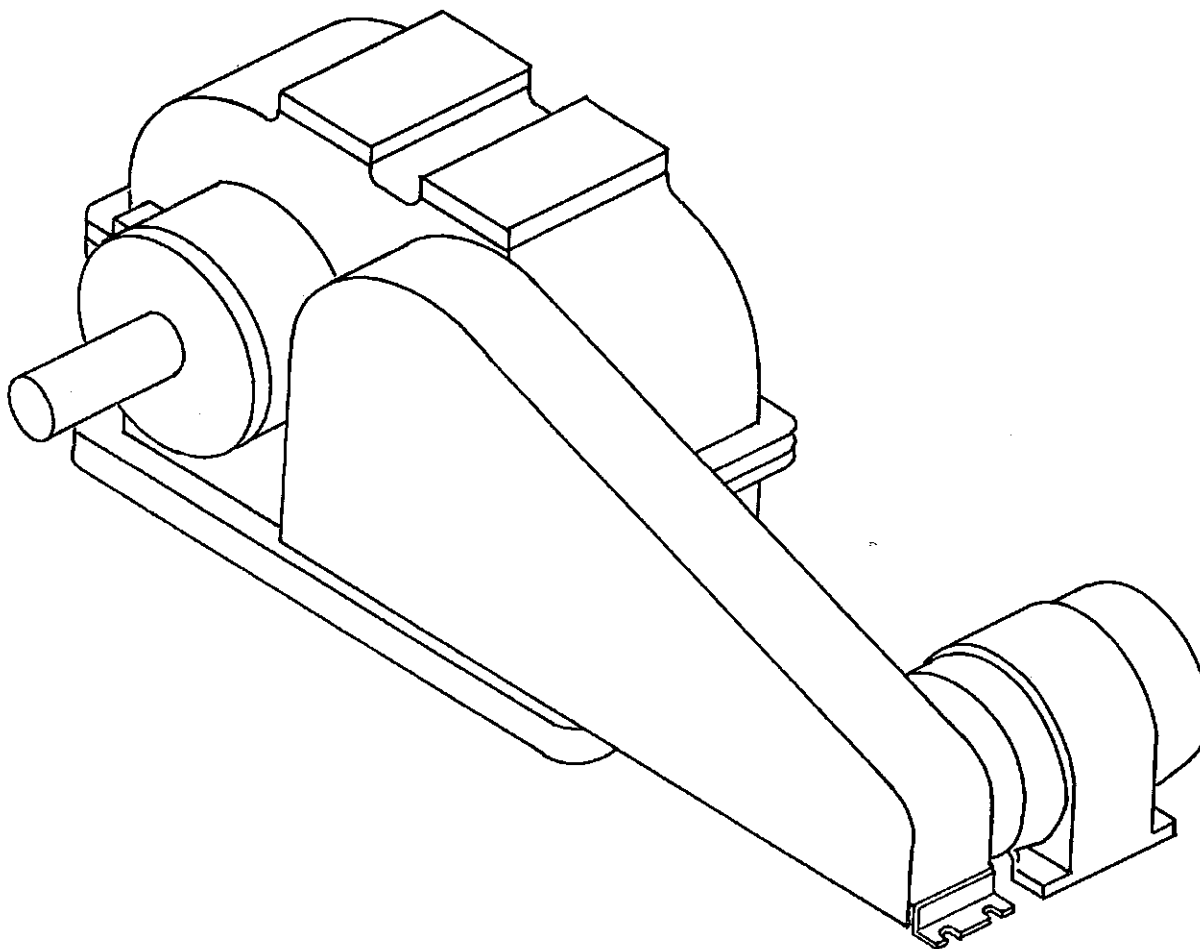
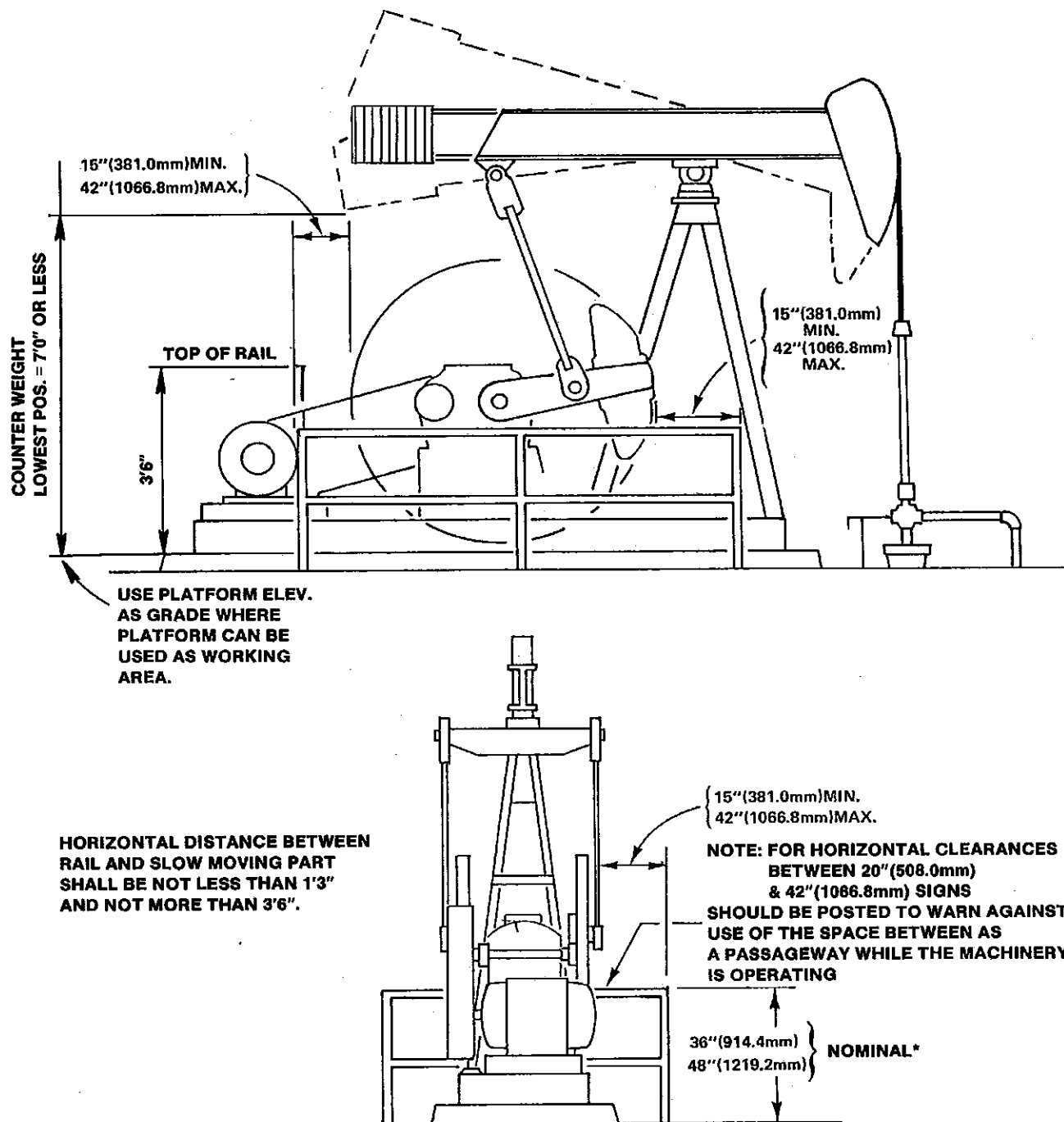

FIG. A.1
EXAMPLE OF BELT GUARD



*Field Modification of guard may be required to achieve this dimension.

FIG. A.2

EXAMPLE OF COUNTERBALANCE GUARD

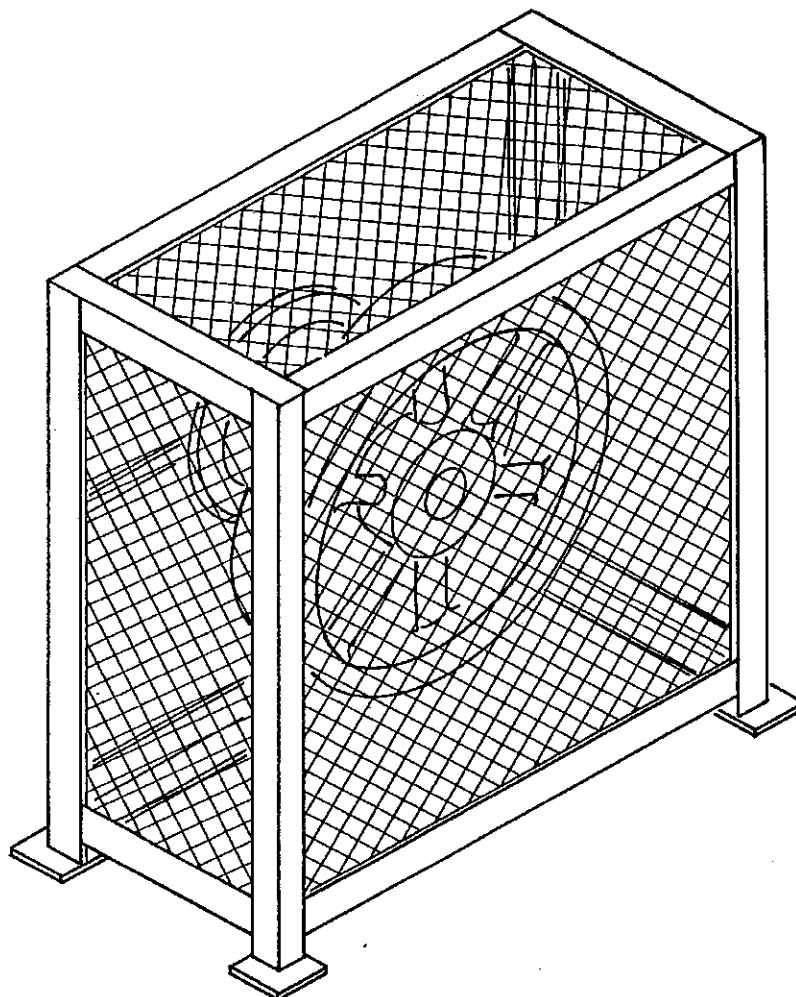
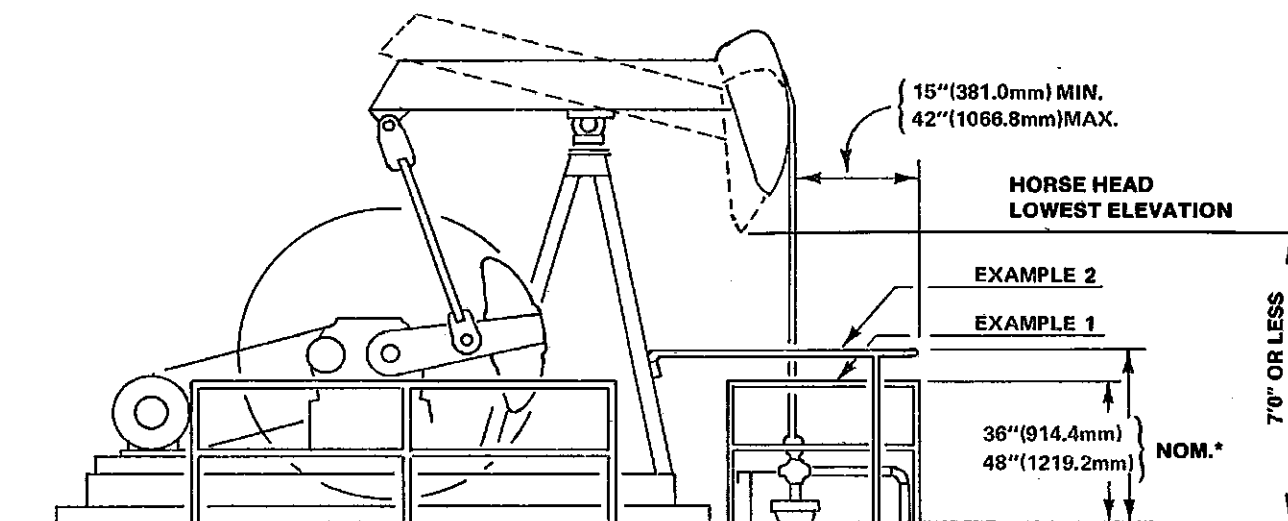

FIG. A.3

EXAMPLE OF FLYWHEEL GUARD



*Field Modification of guard may be required to achieve this dimension.

WHERE LOWEST ELEV. OF COUNTERWEIGHT OR HORSE HEAD IS 7'0" OR LESS, RAIL SHALL BE PROVIDED TO MAINTAIN HORIZONTAL CLEARANCE OF 1'3" TO 3'6".

EXAMPLE 1

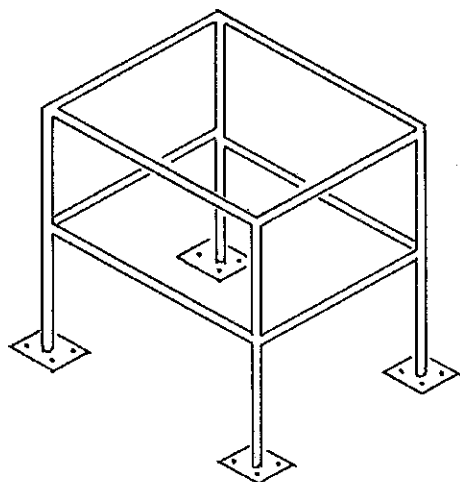

EXAMPLE 2

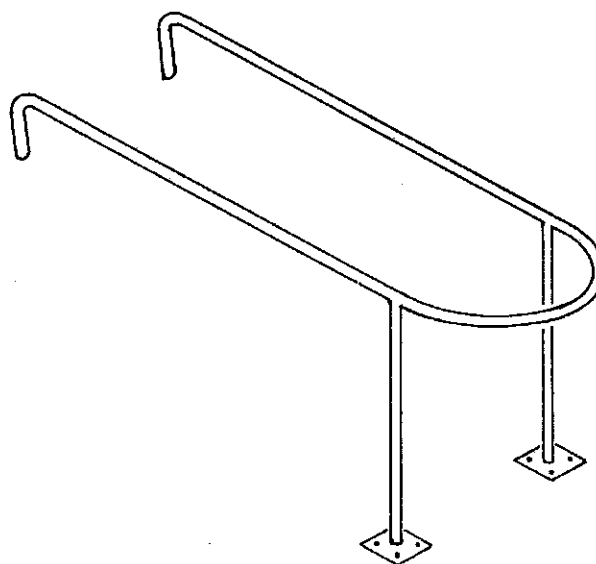

FIG. A.4

EXAMPLES OF HORSEHEAD GUARDS

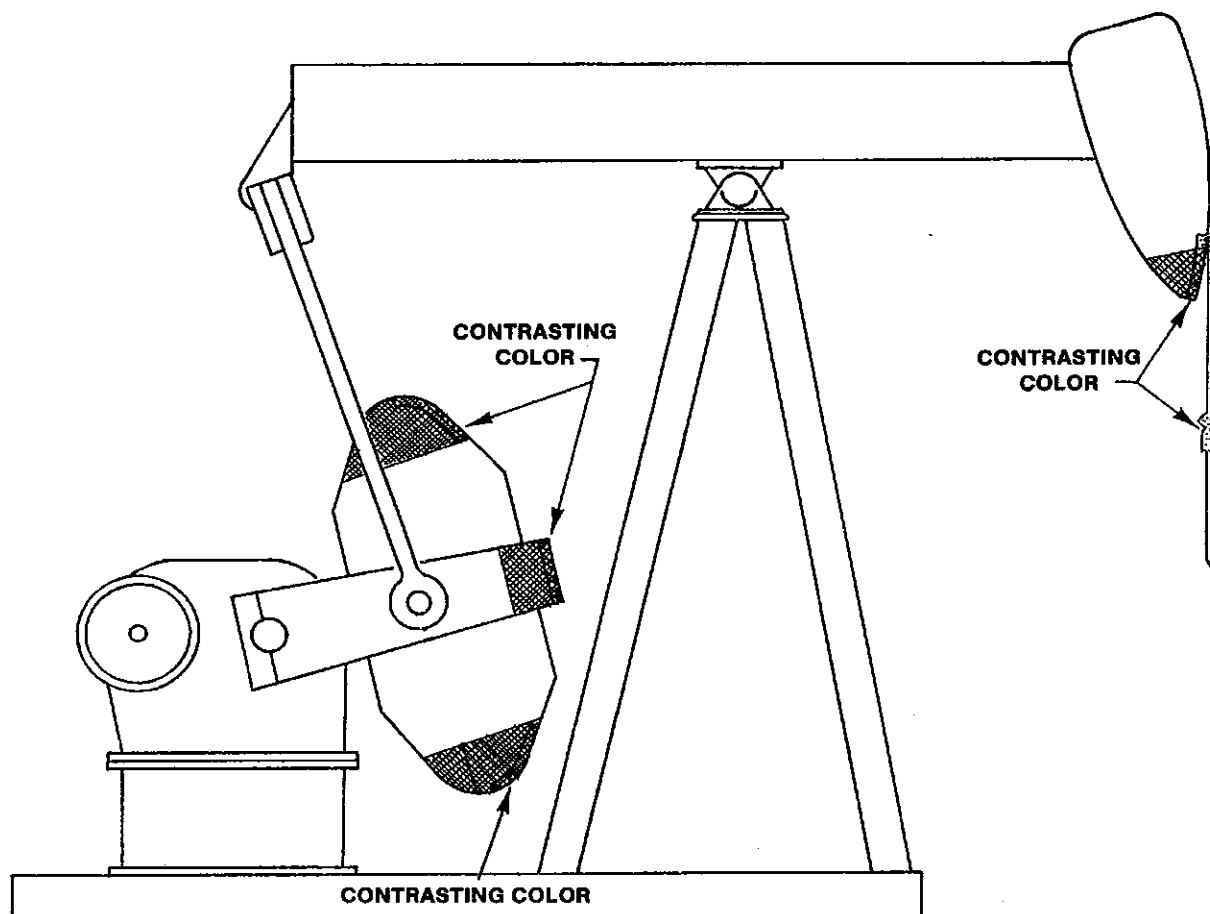

FIG. A.5
EXAMPLE OF COLOR CODE APPLICATION

Areas indicated to be painted with contrasting color are to be considered minimums. Actual pattern of painted areas is left to the discretion of the manufacturer or operator.

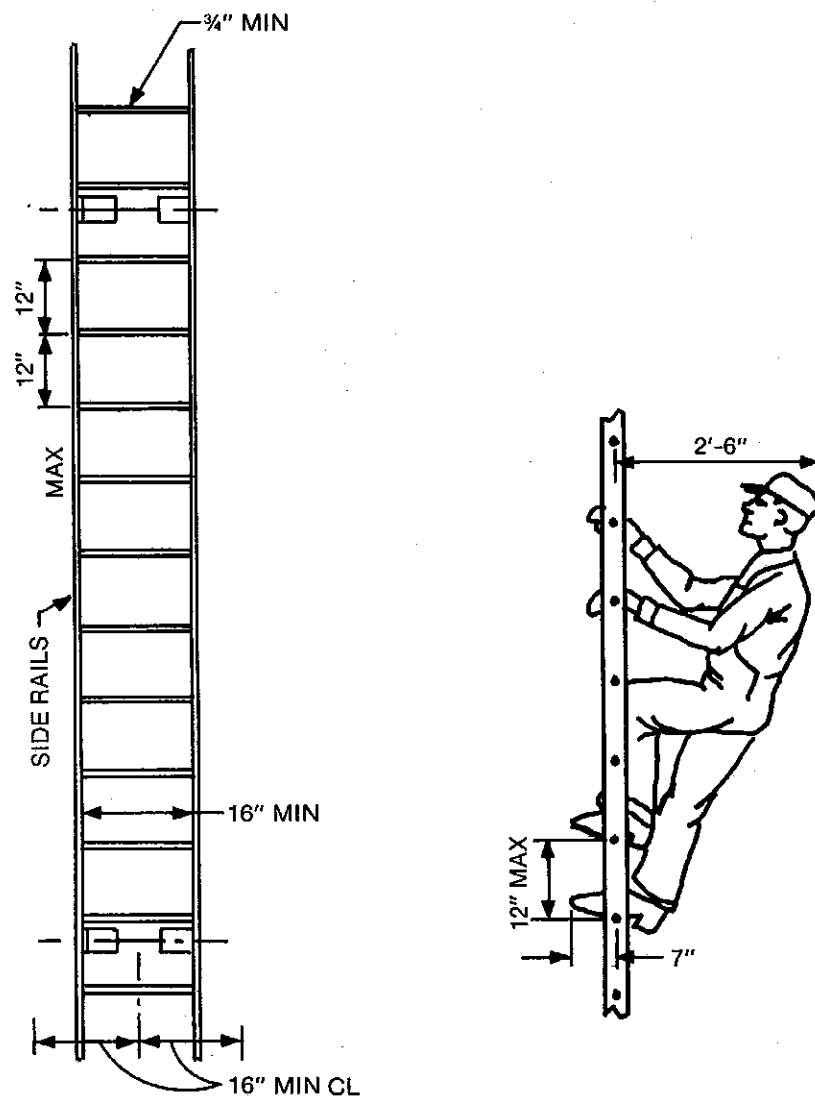

FIG. A.6
RAIL LADDER WITH BAR STEEL RAILS AND
ROUND STEEL RUNGS

MINIMUM LADDER CLEARANCES

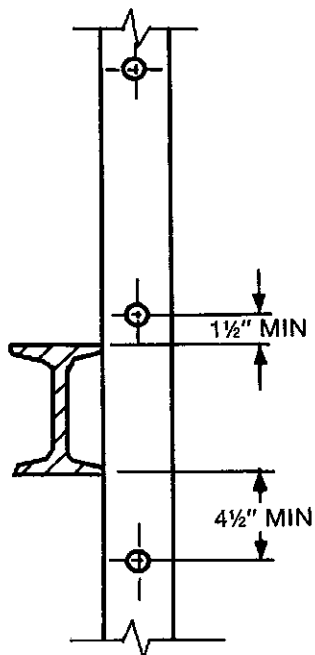

FIG. A.7
CLEARANCE FOR UNAVOIDABLE OBSTRUCTION AT
REAR OF FIXED LADDER

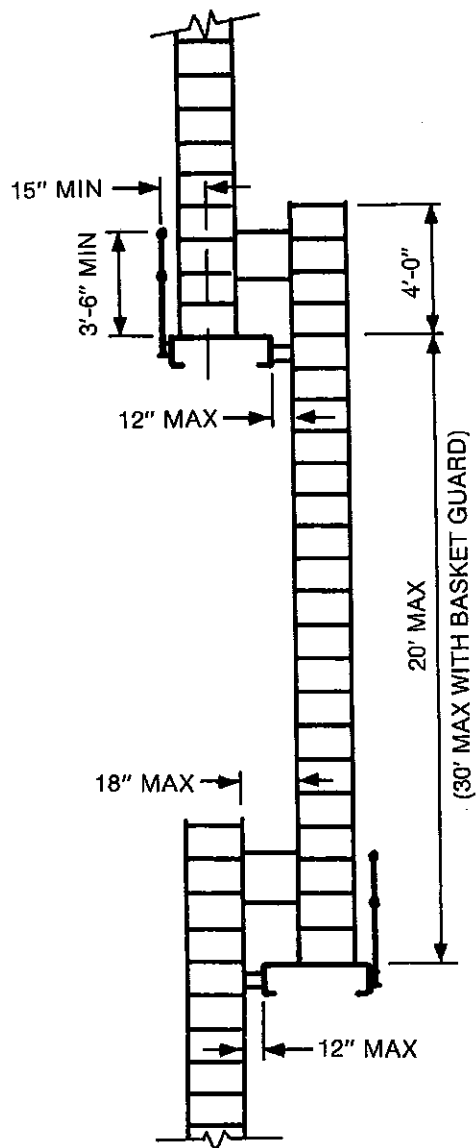
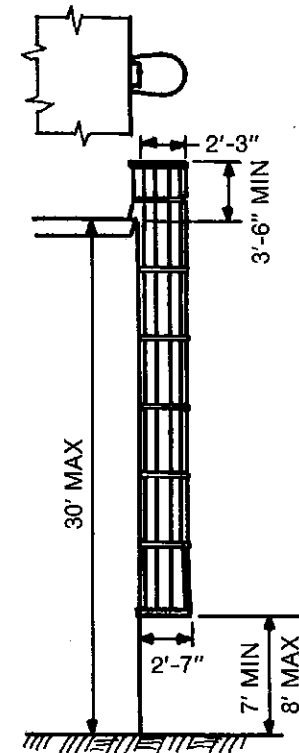

FIG. A.8
OFFSET FIXED LADDER SECTIONS

THROUGH LADDER



ACCESS TO LANDING
PLATFORM THROUGH
LADDER

SIDE-STEP LADDER

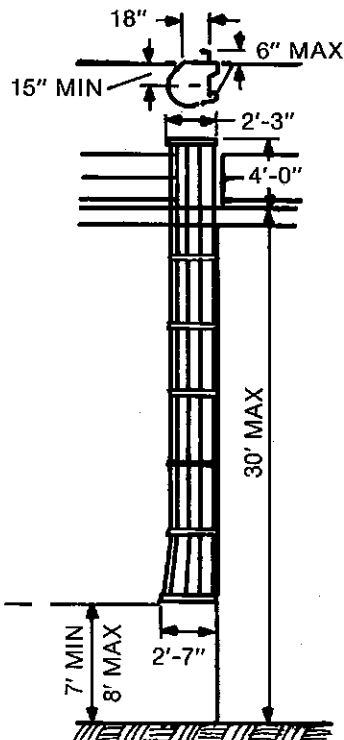

ACCESS Laterally
FROM LADDER

TOP AND BOTTOM
HOOPS ALSO THIS SIZE

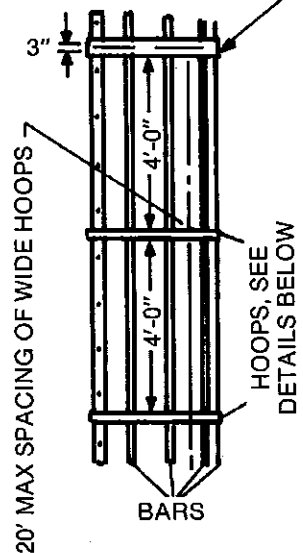

BASKET GUARD

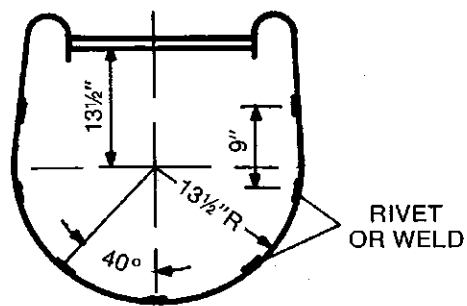

BASKET GUARD HOOP
BAR LADDER

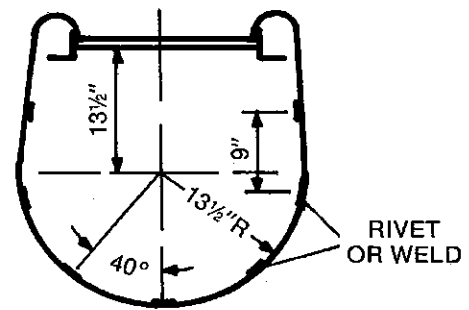

BASKET GUARD HOOP
ANGLE IRON LADDER

FIG. A.9

Order No. 811-05205

Additional copies available from
AMERICAN PETROLEUM INSTITUTE
Publications and Distribution Section
1220 L Street, NW
Washington, DC 20005
(202) 682-8375

